



### Features

- 15,000 square foot indoor Water Park with 2 GIANT Waterslides (Castaway Bay)
- Game Area
- Big D's Bar and Grill (Breakfast, Lunch and Dinner)

### Services

- Complimentary Shuttle Service
- 24-Hour Business Center
- Laundry/Valet Service
- Fitness Center
- Wedding Services
- Complimentary Parking
- Lobby Library
- 24 Hour Grab & Go

### Room Amenities

- Ultra Plush Mattress
- Ultra Plush Bedding Set
- Deluxe Shower Head for a Great Shower Experience
- Curved Shower Rod for More Room
- Single Serve Fresh in Room Coffee
- In-Room Movies and Video Games
- Free High-Speed Wireless Internet

### Banquet & Convention Equipment

- Slide Projectors
- Overhead Projector
- LCD Projector
- Screens
- Televisions etc.
- Flipchart Stand, Paper & Markers
- Flipchart Stand - no paper
- Whiteboard & Markers
- Easels
- Speaker Phone
- Portable PA System
- Portable PA System w/Handheld Wireless Mic
- High Speed Internet Service
- A/V Cart
- Extension Cord or Powerstrip
- Microphone - Handheld Wired
- Microphone - Handheld Wireless
- Microphone - Lavalier Wireless
- Photocopies

Business or Leisure - The Ramada Plaza Green Bay is in step with today's travelers. You'll find free high-speed Internet and Plaza Comforts featuring our ultra plush mattresses and bedding sets. The addition of Big D's full-service restaurant and bar, and the new Water Park sporting two waterslides makes the Ramada Plaza Green Bay the perfect place for corporate meetings, social functions, or family fun!

Relax in our guest library or enjoy the big game in our lobby living room. We have thought of everything to make you feel right at home! Late night craving? We feature a 24-hour Grab & Go to satisfy all your snack or sundry needs!



  
**RAMADA**<sup>®</sup>  
 P L A Z A

2750 Ramada Way  
 Green Bay, WI 54304  
 ph: 920-499-0631  
 fax: 920-499-5476  
[www.greenbayramada.com](http://www.greenbayramada.com)

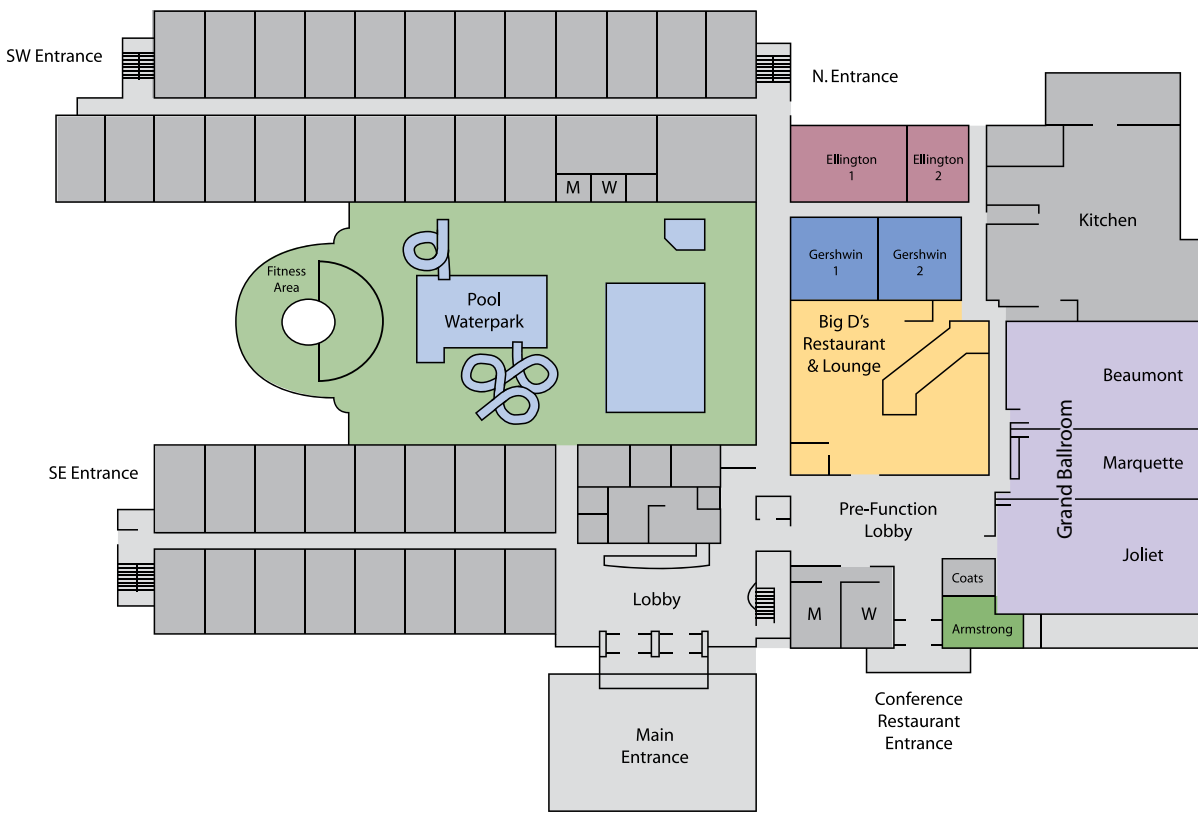

Name	Dimensions	Sq. Ft.	Theater	Classroom	Round/Sq.	Banquet	U-shape	
Grand Ballroom	-	3,564'	375	175	232	300	-	
Beaumont	20'x38'	1,176	80	45	64	80	30	
Marquette	21'x38'	798	50	30	48	60	20	
Joliet	35'x48'	1,680	120	60	96	120	40	
Ellington	21'x45'	945	50	30	48	70	25	
Ellington I	21'x30'	630	30	24	32	48	20	
Ellington II	21'x15'	315	20	10	16	16	-	
Gershwin	26'x40'	1,040	60	36	48	70	30	
Gershwin I	26'x20'	520	30	20	24	30	15	
Gershwin II	26'x20'	520	30	20	24	30	15	
Armstrong	12'x20'	240	Conference Style Seating Only - 12 person max					

Actual capacity will decrease with the addition of buffet sets or special set-up needs

